

33 Illuka Street, Buderim

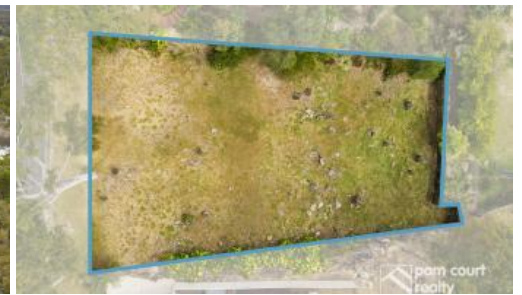

## 850m2 block in Buderim Meadows!

This rare opportunity is presented to the market to secure a 850m2 block in a highly sought-after Buderim Meadows cul-de-sac location. Design your dream family home to take advantage of the north-easterly aspect and stunning views offered by your elevated position.

Located within a quiet treed cul-de-sac and within close proximity to Schools, Shopping, Medical Centre, University and Mooloolaba's beautiful beach and café precinct.

- Elevated North Easterly 850m2 block
- Bush views and ocean breezes
- Quiet cul-de-sac location
- Mountain Creek School Zone
- Close to schools and shops

The above information provided has been furnished to us by the vendor/s. We have not verified whether or not that information is accurate and do not have any belief in one way or the other in its accuracy. We do not accept any responsibility to any person for its accuracy and do no more than pass it on. All interested parties should make and rely upon their own inquiries in order to determine whether or not this information is in fact accurate.

📏 850 m2

Price SOLD for \$350,000

Property Type Residential

Property ID 154

Land Area 850 m2

### Agent Details

Mandy Watson - 0412 988 487

### Office Details

Mountain Creek  
Suite 4, Mountain Creek Medical  
Centre Karawatha Drive Mountain  
Creek QLD 4557 Australia  
07 5444 8188